

鹤山市2022年度第四十五批次城镇建设用地图(勘测定界图)(HC647)

鹤山市鹤城镇工业三区

单位: m.m²

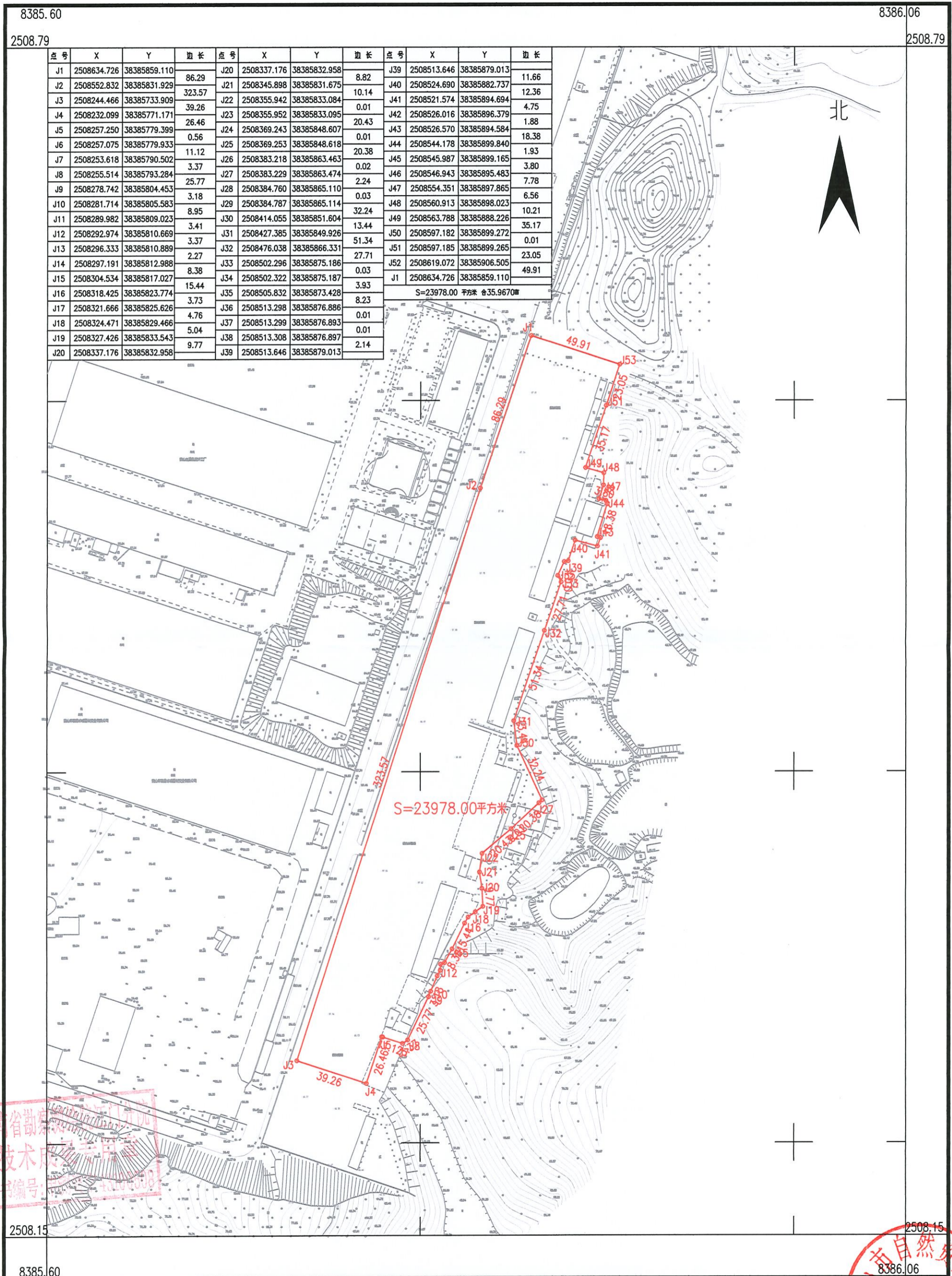

点号	X	Y	边长	点号	X	Y	边长	点号	X	Y	边长
J1	2508634.726	38385859.110		J20	2508337.176	38385832.958		J39	2508513.646	38385879.013	11.66
J2	2508552.832	38385831.929	86.29	J21	2508345.898	38385831.675	8.82	J40	2508524.690	38385882.737	12.36
J3	2508244.466	38385733.909	323.57	J22	2508355.942	38385833.084	10.14	J41	2508521.574	38385894.694	4.75
J4	2508232.099	38385771.171	39.26	J23	2508355.952	38385833.095	0.01	J42	2508526.016	38385896.379	1.88
J5	2508257.250	38385779.399	26.46	J24	2508369.243	38385848.607	20.43	J43	2508526.570	38385894.584	18.38
J6	2508257.075	38385779.933	0.56	J25	2508369.253	38385848.618	0.01	J44	2508544.178	38385899.840	1.93
J7	2508253.618	38385790.502	11.12	J26	2508383.218	38385863.463	20.38	J45	2508545.987	38385899.165	3.80
J8	2508255.514	38385793.284	3.37	J27	2508383.229	38385863.474	0.02	J46	2508546.943	38385895.483	7.78
J9	2508278.742	38385804.453	25.77	J28	2508384.760	38385865.110	2.24	J47	2508554.351	38385897.865	6.56
J10	2508281.714	38385805.583	3.18	J29	2508384.787	38385865.114	0.03	J48	2508560.913	38385898.023	10.21
J11	2508289.982	38385809.023	8.95	J30	2508414.055	38385851.604	32.24	J49	2508563.788	38385888.226	35.17
J12	2508292.974	38385810.669	3.41	J31	2508427.385	38385849.926	13.44	J50	2508597.182	38385899.272	0.01
J13	2508296.333	38385810.889	3.37	J32	2508476.038	38385866.331	51.34	J51	2508597.185	38385899.265	23.05
J14	2508297.191	38385812.988	2.27	J33	2508502.296	38385875.186	27.71	J52	2508619.072	38385906.505	49.91
J15	2508304.534	38385817.027	8.38	J34	2508502.322	38385875.187	0.03	J1	2508634.726	38385859.110	49.91
J16	2508318.425	38385823.774	15.44	J35	2508505.832	38385873.428	3.93	S=23978.00 平方米 435.9670米			
J17	2508321.666	38385825.626	3.73	J36	2508513.298	38385876.886	8.23				
J18	2508324.471	38385829.466	4.76	J37	2508513.299	38385876.893	0.01				
J19	2508327.426	38385833.543	5.04	J38	2508513.308	38385876.897	0.01				
J20	2508337.176	38385832.958	9.77	J39	2508513.646	38385879.013	2.14				

湖南省勘察测绘院
江门分院

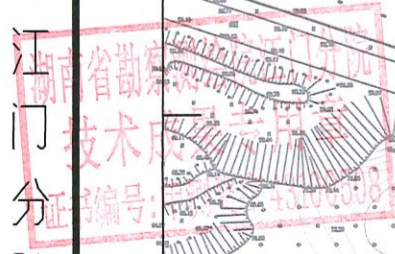

2023年1月数字化制图
2000国家大地坐标系: 中央子午线114度
1985国家高程基准, 等高距为1米
2007年版式

1:2000

8385.60

8386.06

2508.79

2508.79

2508.15

2508.15

8385.60

8386.06